

Steering Knuckle COMPONENTS

DISC BRAKE

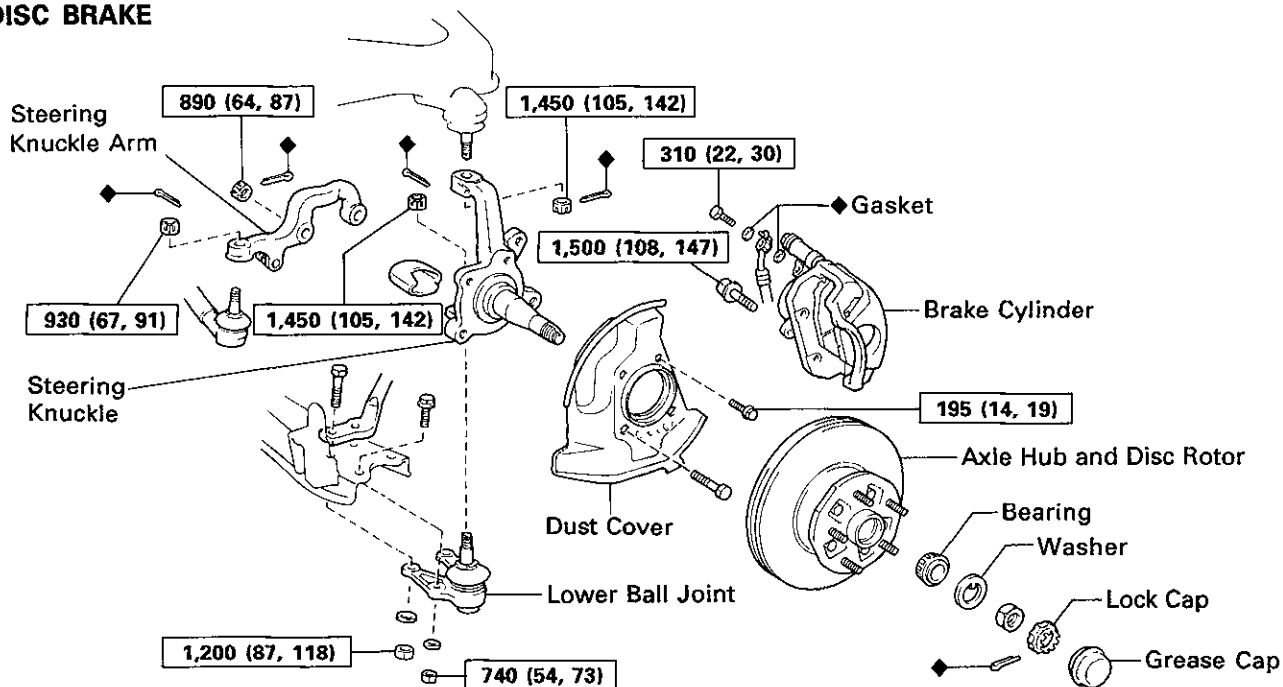

DRUM BRAKE

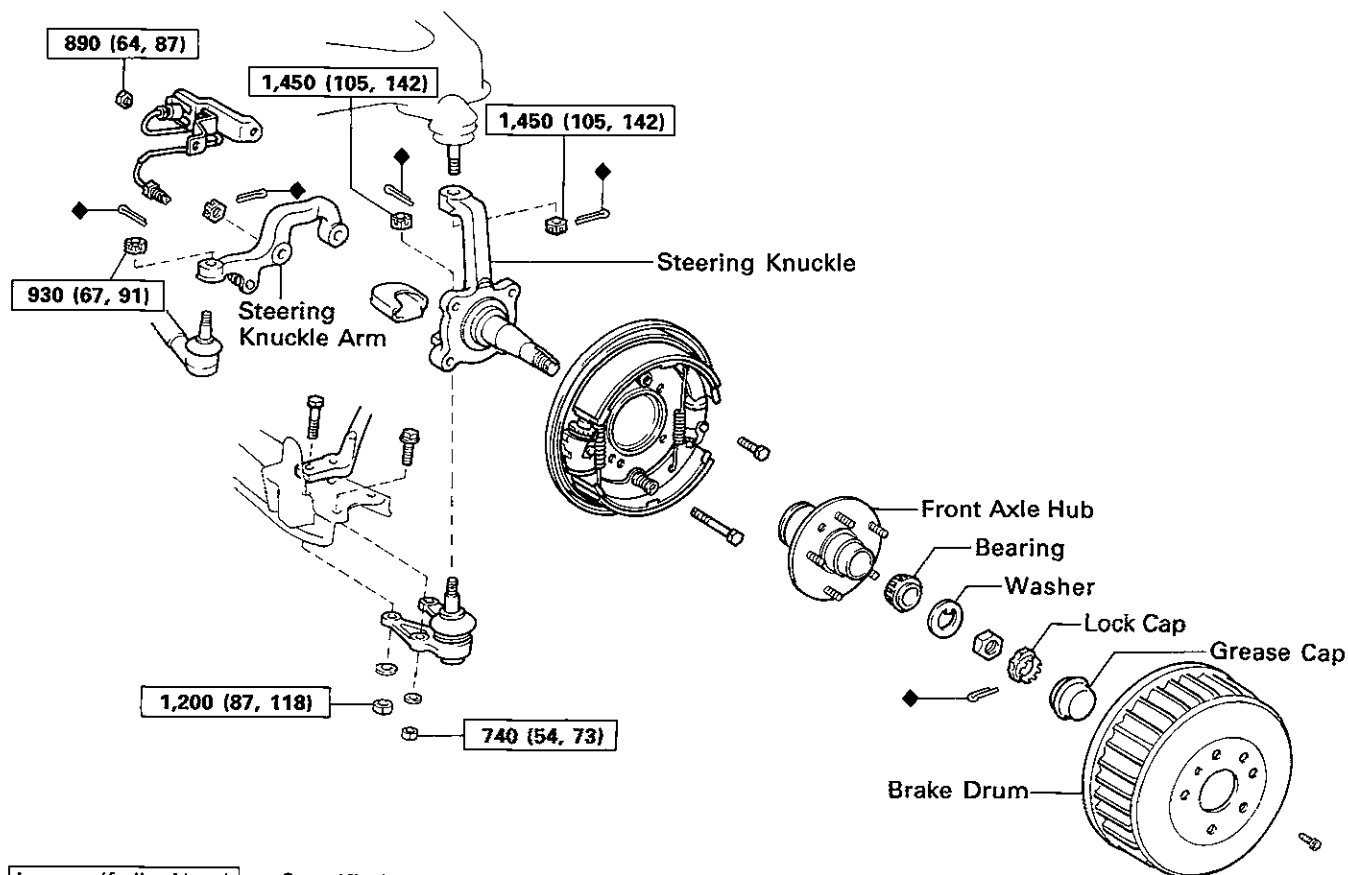

kg-cm (ft-lb, N·m) : Specified torque

◆ Non-reusable part

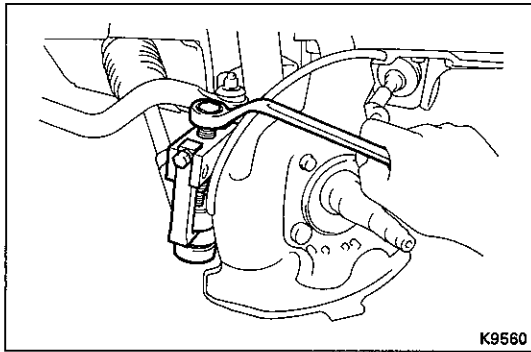

REMOVAL OF STEERING KNUCKLE

1. REMOVE FRONT AXLE HUB

(See page SA-13)

2. DISCONNECT TIE ROD

(a) Remove the cotter pin and nut.

(b) Using SST, disconnect the tie rod from the steering knuckle arm.

SST 09628-62011

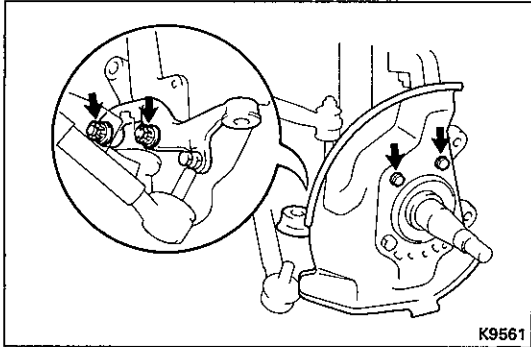

3. (DISC BRAKE)

REMOVE STEERING KNUCKLE ARM AND BRAKE DUST COVER

(a) Remove the two cotter pins, two nuts and steering knuckle arm.

(b) Remove the two bolts and brake dust cover.

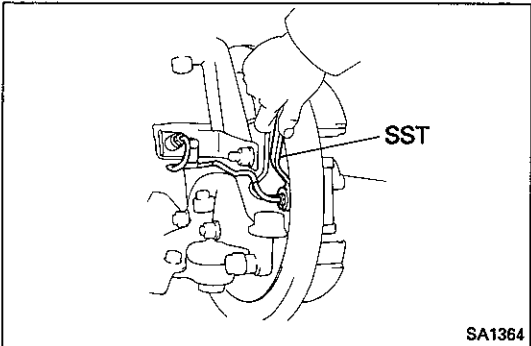

4. (DRUM BRAKE)

DISCONNECT BRAKE TUBE

Using SST, disconnect brake tube from the wheel cylinder.

SST 09751-36011

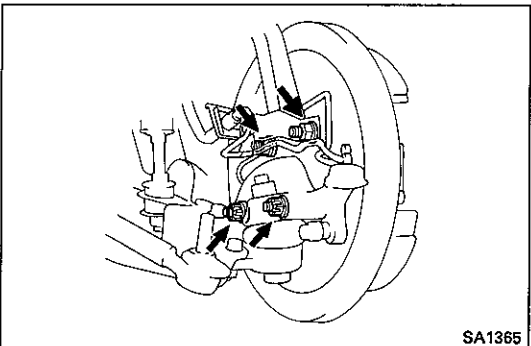

5. (DRUM BRAKE)

REMOVE STEERING KNUCKLE ARM AND BRAKE BACKING PLATE

(a) Remove the two cotter pins, two nuts and steering knuckle arm.

(b) Remove the two nuts and brake backing plate with brake shoes.

6. REMOVE LOWER BALL JOINT

(See page SA-94)

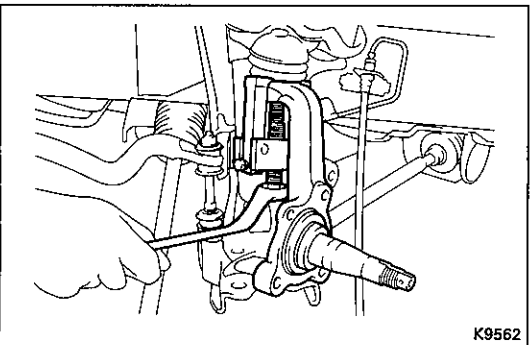

7. REMOVE STEERING KNUCKLE

(a) Remove the cotter pin and nut.

(b) Using SST, remove the steering knuckle from the upper ball joint.

SST 09628-62011

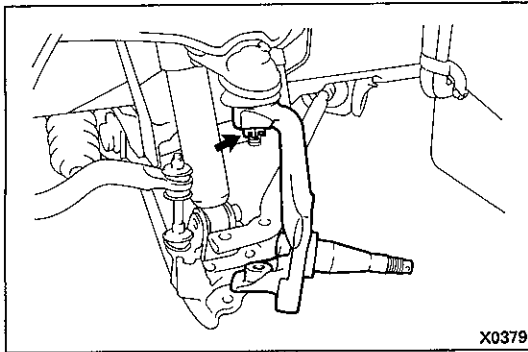

INSTALLATION OF STEERING KNUCKLE

1. TEMPORARILY INSTALL STEERING KNUCKLE

Temporarily install the steering knuckle to the upper ball joint.

2. INSTALL LOWER BALL JOINT (See page SA-95)

3. TORQUE NUT

(a) Torque the nut of the upper ball joint.

Torque: 1,450 kg-cm (105 ft-lb, 142 N·m)

(b) Install a new cotter pin.

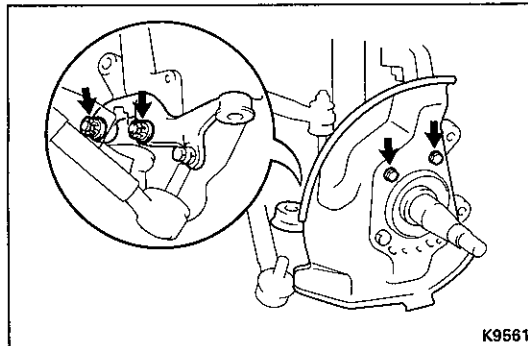

4. (DISC BRAKE) INSTALL BRAKE DUST COVER AND STEERING KNUCKLE ARM

(a) Install the brake dust cover and the two bolts.

Torque: 195 kg-cm (14 ft-lb, 19 N·m)

(b) Install the steering knuckle arm with two bolts and two nuts.

Torque: 890 kg-cm (64 ft-lb, 87 N·m)

(c) Install two new cotter pins.

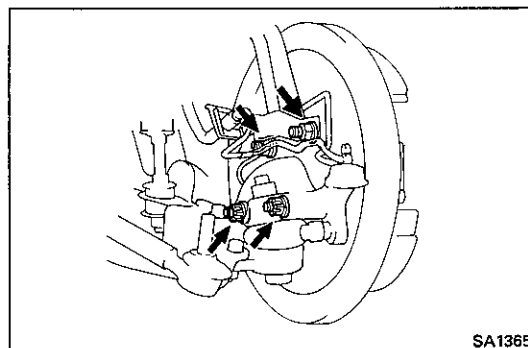

5. (DRUM BRAKE) INSTALL BRAKE BACKING PLATE AND STEERING KNUCKLE

(a) Install the brake backing plate and brake hose bracket with two bolts and two nuts.

Torque: 890 kg-cm (64 ft-lb, 87 N·m)

(b) Install the steering knuckle arm with two bolts and two nuts.

Torque: 890 kg-cm (64 ft-lb, 87 N·m)

(c) Install two new cotter pins.

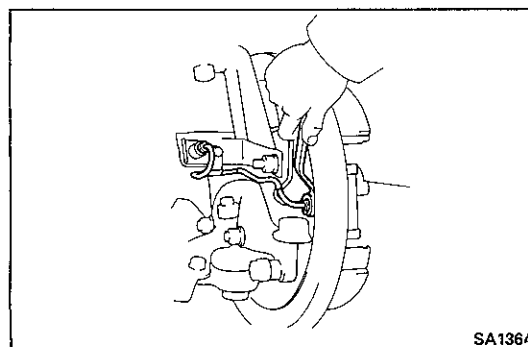

6. (DRUM BRAKE) CONNECT BRAKE TUBE

Using SST, connect the brake tube to the wheel cylinder.

SST 09751-36011

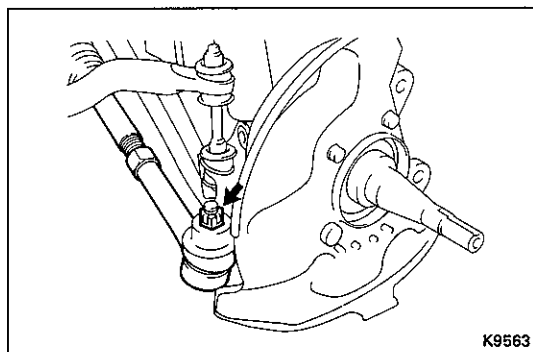
**7. CONNECT TIE ROD**

(a) Connect the tie rod to the steering knuckle arm.

Torque: 930 kg-cm (67 ft-lb, 91 N-m)

(b) Install a new cotter pin.

8. INSTALL FRONT AXLE HUB

(See page SA-15)

9. (DRUM BRAKE)

BLEED BRAKE SYSTEM AND CHECK FLUID LEAKAGE

10. CHECK FRONT WHEEL ALIGNMENT

(See page SA-3)